

1020-CK

Check-weighing Controller

SENSOR
TECHNIQUES LIMITED

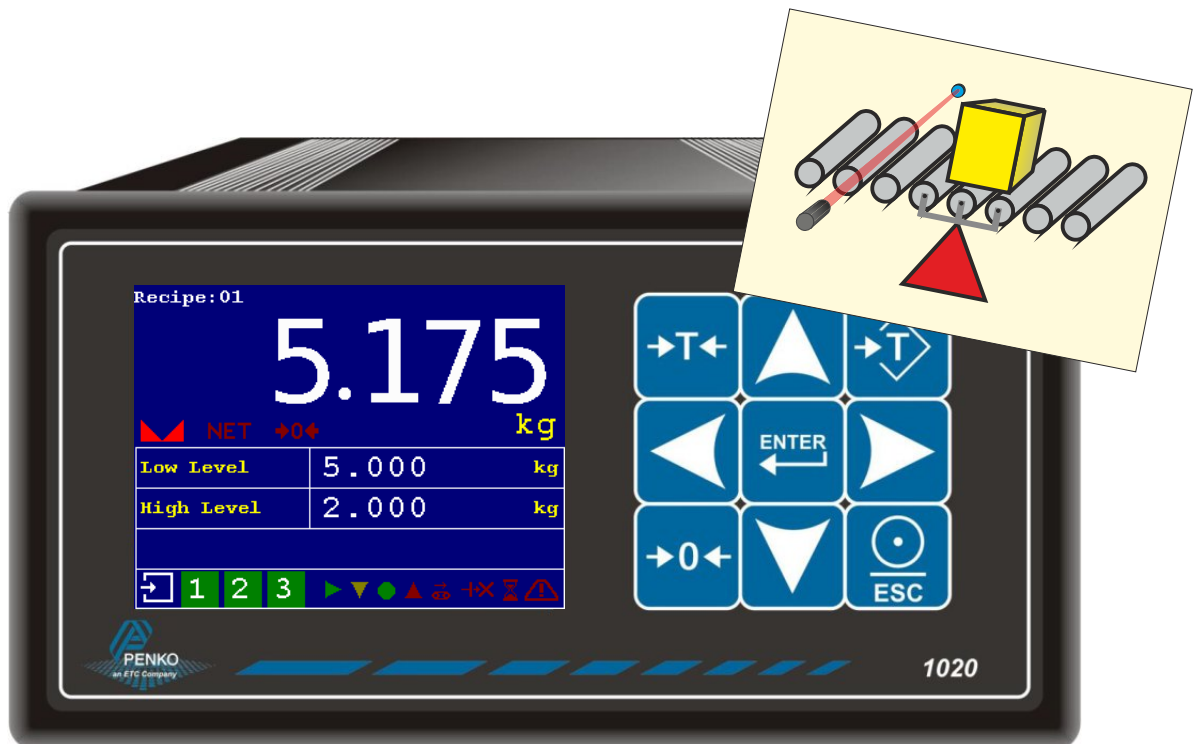

Check-weighing Controller, 1020-CK

- Designed for use with in-line check-weighers
- 1600 samples per second, 24 bit ADC 0.4 uV/div
- Input for photocell to trigger weighing sequence.
- Solid state relay output to reject over & under weights
- Store up to 10 user selectable recipes/setups
- Optional analogue output to control belt speeds
- Batch totals and statistics available
- Menu driven setup and calibration via keypad
- Ethernet & USB interfaces as standard
- High resolution 2.8 inch TFT LCD colour display
- Power supply 18-32 VDC 7.5W max.
- Panel mounting (other types available)

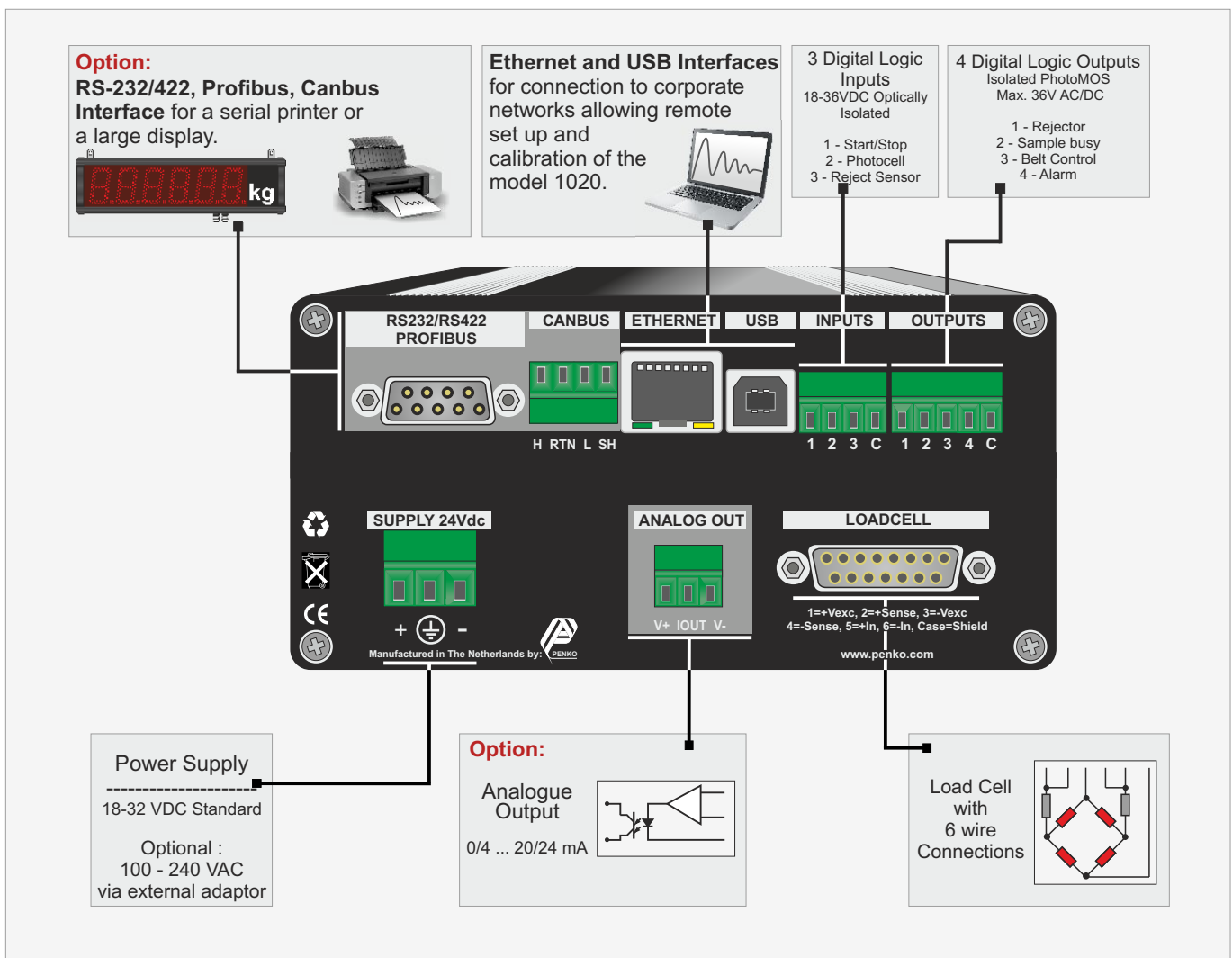

Specification

Specifications are subject to change without prior notice

Linearity	: < 0.005 % F.S.
Excitation Voltage	: 5 VDC, capable of driving up to 8 load cells with 350 Ohm bridges
Input Signal Range	: -2.5 mV to +11.25 mV (-0.5mV/V to +2.25 mV/V)
Digital Filter	: High performance digital filters 1 -10Hz adjustable.
Analogue Output (Option VA)	: 4-20mA, 0-20mA, 4-24 mA and 0-24mA
Digital Display	: 2.8 inch (71 mm) high resolution TFT LCD colour display
ADC Resolution and Speed	: 24 Bit ADC with up to 1600 samples per second
Digital Inputs	: 3 optically isolated; 18 -36 VDC PNP or NPN
Digital Outputs	: 4 isolated PhotoMOS outputs Max 36V DC or AC 0.5A nominal PNP or NPN
Computer Interface	: Ethernet and USB as standard. Optional RS232/422, Canbus and Profibus interfaces available
Temperature Effect	: Zero < ± 2 ppm/°C and Span < ± 2 ppm/°C
Temperature Range	: -10°C to +40°C
Housing	: Extruded Aluminium, Stainless steel available by special order (different dimensions)
Dimensions	: 150 x 78 x 87 mm excluding connectors, Weight approx. 0.9 kg
Power Supply	: 24 VDC (18-32VDC) standard, 100 to 240 VAC optional external power supply

DS1020-CK-1, 04/13